



USER MANUAL

GETTING TO KNOW THE UNIDEN® LINK 4G:

The Uniden® Link 4G will boost your cellular signal, expand your service coverage area, enhance voice call quality and significantly increase data speeds.

The Uniden® Link 4G is equipped with internal automatic oscillation protection. The booster constantly monitors the environment in which it is operating and automatically adjusts the gain/power accordingly to protect itself while giving you a maximum coverage footprint. It is easy and simple to install and you can be up and running in minutes.

TECHNICAL SUPPORT CONTACT INFORMATION

Live Help: unidencellular.com
Email: support@unidencellular.com
Toll Free: 1-800-239-0394

2 year warranty against manufacturing defects.
Does not include misuse or customer damage.
Original bill of sale is required for all warranty claims.

Your Kit Includes:



Uniden® Link 4G
Cradle Style Cellular
Signal Booster



Mounting Base
with suction cup



Metal Plates
with Adhesive



Outdoor Magnet
Mount Antenna



12V
Power Supply

PRE INSTALLATION STEPS

1. Connect the Uniden® Link 4G Cradle Booster to the mounting base. Align the 4 holes on the back of the booster with the 4 posts on mounting base and slide down to secure.
2. Stick the Metal Plate to the back of your phone in the middle to ensure your phone sticks to the magnet on the cradle.

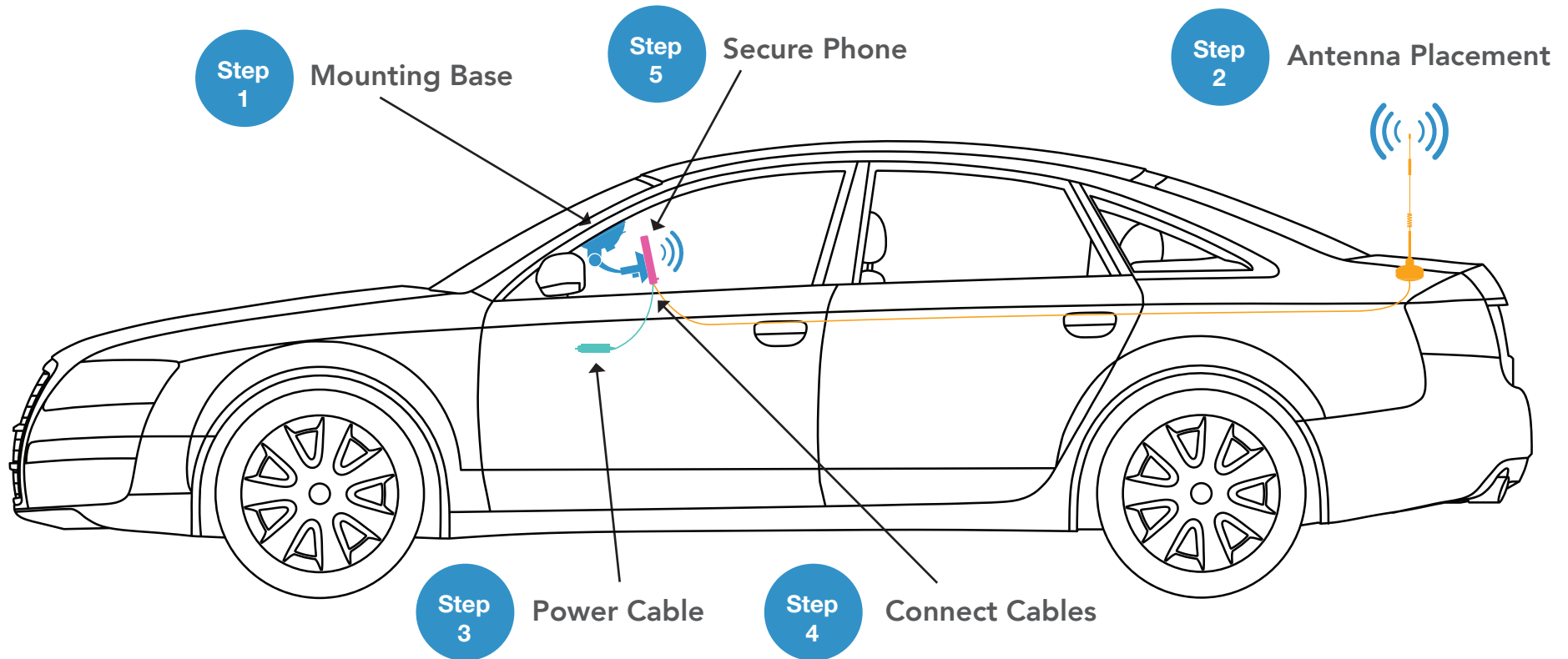

STEP ONE

Mounting Base

Find a suitable spot on your windshield and secure the mounting base with the suction cup

STEP TWO

Antenna Placement

Mount the outdoor antenna on your vehicle. (On the roof or the trunk area) Route the cable to the cradle booster location.

STEP THREE

Power Cable

Insert the Power Cable into the 12V plug in your vehicle.

STEP FOUR

Connect Cables

Connect the power cable and the antenna cable to the bottom of the cradle booster.

STEP FIVE

Secure Phone

Insert the Phone onto cradle to start enjoying your boosted cellular signal